

spiralna cev
SC fi DN (L=?)

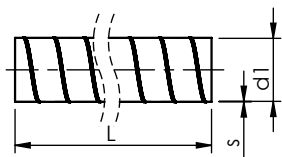

standardno: L=3m; d1=DN

koleno
K α° fi DN (r=?D)

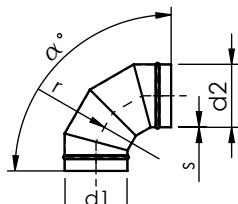

standardno: r=D
d(1,2)=DN(1,2) -2mm

spojni kos notranji
SKN fi DN

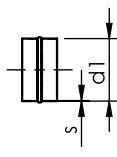

d1=DN-2mm

spojni kos zunanji
SKZ fi DN

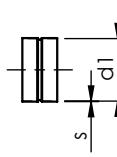

d1=DN

reducirni sredinski kos
RSK fi DN

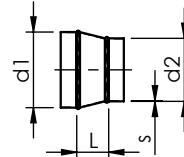

d(1,2)=DN(1,2) -2mm

reducirni zamačni kos
RZK fi DN

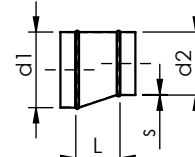

d(1,2)=DN(1,2) -2mm

T kos pravokotni
TKP fi DN1/fi DN2

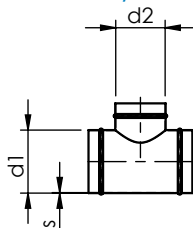

d(1,2)=DN(1,2) -2mm

T kos pod kotom
TKK fi DN1/fi DN2, $\alpha=?$

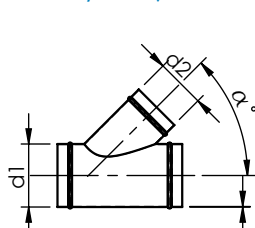

d(1,2)=DN(1,2) -2mm

reducirani T kos pravokotni
RTKP fi DN1/ fi DN3 -90° /fi DN2

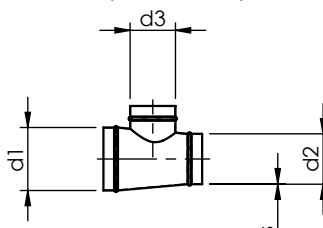

d(1,2,3)=DN(1,2,3) -2mm

reducirani T kos pod kotom
RTKK fi DN1/ fi DN3, $\alpha=?$ /fi DN2

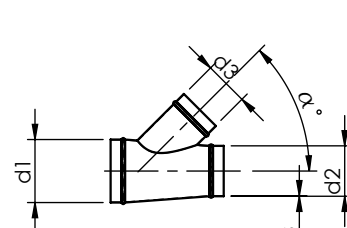

d(1,2,3)=DN(1,2,3) -2mm

razvodni Y kos
RY fi DN1/fi DN2 (/fi DN3, $\alpha=?$)

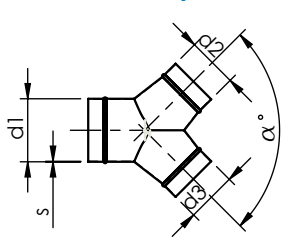

standardno: $\alpha=90^\circ$
d(1,2,3)=DN(1,2,3) -2mm

križni X-kos
KX fi DN1/fi DN2 (/fi DN3)

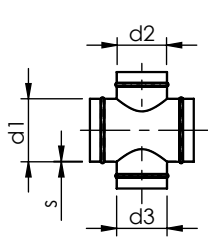

d(1,2,3)=DN(1,2,3) -2mm

reducirani križni X-kos pod kotom
RXKK fi DN1/ fi DN3, $\alpha=?$ /fi DN4, $\beta=?$ /fi DN2

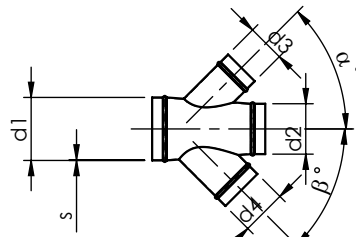

standardno: $\alpha=\beta=45^\circ$
d(1,2,3,4)=DN(1,2,3,4) -2mm

cevni nastavek
CN fi DN

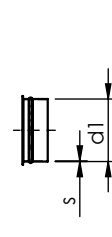

d1=DN-2mm

sedlasti nastavek raven
SNR fi DN1/ fi DN2

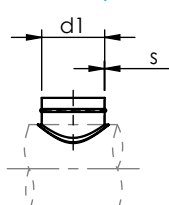

d1=DN-2mm

sedlasti nastavek pod kotom
SNK fi DN1, $\alpha=?$ /fi DN2

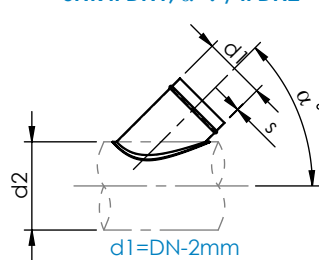

d1=DN-2mm

ežaža
ET fi DN, h=?, L=?

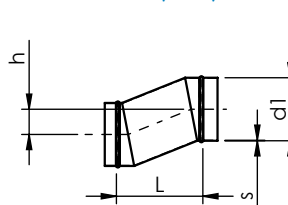

d1=DN-2mm

končni pokrov
KP fi DN

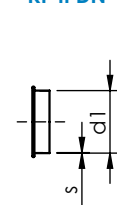

d1=DN-2mm

strešna izhodna kapa
SIK fi DN

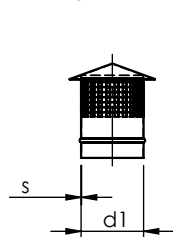

d1=DN-2mm

strešni izpihovalni kos z mrežo
SIA-90° fi DN

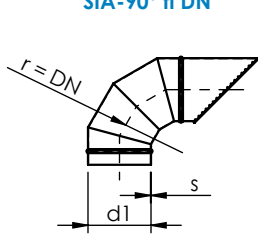

d1=DN-2mm

strešni izpihovalni kos z mrežo
SIA-120° fi DN

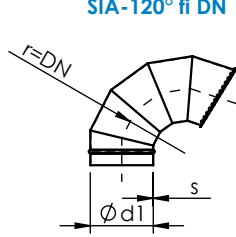

d1=DN-2mm

stranski izpihovalni kos z mrežo
SIE fi DN

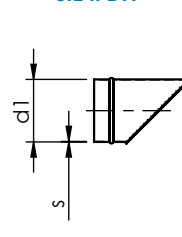

d1=DN-2mm

strešni deflektor z mrežo
DEF fi DN

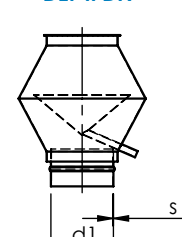

d1=DN-2mm

